

American Institute of Aeronautics and Astronautics Houston Section

In Collaboration with INCOSE Presents

Annual Technical Symposium 2014

**NASA/JSC Gilruth Center
Houston, Texas
Friday, May 9, 2014**

PROGRAM

General Chair

Clay Stangle

Organizing Committee

Ellen Gillespie
Michael Frostad
Michael Martin
BeBe Kelly-Serrato
Irene Chan
Laura Sarmiento
Douglas Yazell
Ben Edwards
Technical Committee Chairs





CONTENTS

CONTENTS	3
ACKNOWLEDGEMENTS	3
PROGRAM SUMMARY	5
SYMPOSIUM LOCATION	10
SYMPOSIUM INFORMATION	13
REGISTRATION	13
SPECIAL EVENTS	14
TECHNICAL PROGRAM	15
TECHNICAL SESSIONS	15
PRESENTATIONS	15

THANKS TO OUR 2014 CORPORATE SPONSORS



JACOBS®

PROGRAM SUMMARY

7:45 AM – 4:30 PM	Registration Desk on First Floor	Alamo Ballroom
8:00 AM - 9:00 AM	<i>Speaker:</i> Pete Hasbrook - State of the ISS	Alamo Ballroom
Session A 9:00 AM – 10:15 AM	<ol style="list-style-type: none"> 1. Climate Change 2. Safety and Mission Assurance (S&MA) 3. Space Commercialization 4. INCOSE 	<p>Discovery</p> <p>Rio Grande</p> <p>Longhorn</p> <p>Lone Star</p>
Session B 10:30 AM – 11:45 AM	<ol style="list-style-type: none"> 1. Climate Change 2. S&MA 3. GN&C 4. INCOSE 	<p>Discovery</p> <p>Rio Grande</p> <p>Longhorn</p> <p>Lone Star</p>
12:00 NOON – 1:30 PM	Lunch	Alamo Ballroom
12:00 PM – 1:30 PM	<i>Space Commercialization Panel</i> <i>Speakers:</i> Former astronauts Chris Ferguson, Lee “Bru” Archambault, and Arturo Machuca from the Houston Airport Director's Office	Alamo Ballroom
Session C 1:45 PM – 3:00 PM	<ol style="list-style-type: none"> 1. Robotics and History 2. Astrodynamics 3. EVA and Space Exploration 4. INCOSE 	<p>Discovery</p> <p>Rio Grande</p> <p>Longhorn</p> <p>Lone Star</p>
<p>Social at Perry's Steakhouse</p> <p>487 Bay Area Blvd., Houston, TX 77058</p>		

Morning Program – Session A

8:00 - 9:00	Morning Key Note Speaker – Pete Hasbrook			
	Discovery (1)	Rio Grande (2)	Longhorn (3)	Lone Star (4)
	Session A-1: Theme – Climate Change Chair: Douglas Yazell	Session A-2: Theme – S&MA Chair: Roger Kleinhammer	Session A-3: Theme – Space Commercialization Chair: Steve Everett	Session A-4: Theme – Systems Eng (INCOSE)
9:00 - 9:25	A-1.1 Climate Change Science and Public Policy Douglas Yazell and Daniel Cohan	A-2.1 Building a Database for a Quantitative Model Joseph Kahn	A-3.1 Technology Transfer and Commercialization Kumar Krishen, Ph.D	INCOSE-1 Why Do I Need To Understand Systems Engineering? Courtney Wright & Tony Williams
9:25 – 9:50		A-2.2 Data Used in Quantified Reliability Models Roger Kleinhammer	A-3.2 Accelerating Space Commercialization Alex Monchak	
9:50 - 10:15		A-2.3 The “Best” Reliability Data for the Job Roger Kleinhammer	A-3.3 INCOSE – An Integrated Approach to Making Mars Exploration More Feasible and Cost Effective Wayne McCandless	INCOSE-1.2 Systems Engineering Requirements Ken Robinson
10:15 – 10:30	15 Minute Break			

Morning Program – Session B

	Discovery (1)	Rio Grande (2)	Longhorn (3)	Lone Star (4)
	Session B-1: Theme – Climate Change Chair: Douglas Yazell	Session B-2: Theme – S&MA Chair: Roger Kleinhammer	Session B-3: Theme – GN&C Chair: Steve Everett	Session B-4: Theme – Systems Eng (INCOSE)
10:30 – 10:55	B-1.1 Climate Change Science and Public Policy Douglas Yazell and Adrian Shelley	B-2.1 An Example of Risk-Informed Design Richard Banke, Ph.D.	B-3.1 Model Based GN&C Simulation and Flight Software Ryan Odegard	INCOSE-2 Virtual Black Boxes for Commercial Airlines: A Systems Engineering Approach Wayne McCandless
10:55 - 11:20				
11:20 – 11:45				
		B-2.2 What to Expect When Your Workplace is in Deep Space Dianna DeMott	B-3.2 Savitzky-Golay-Filter Application to Moment Of Inertia Estimation James Turner	
		B-2.3 Using the Systems Engineering Life-Cycle to Develop and Agent-Based Model and Simulation Ipek Bozkurt	B-3.3 Optimal Covariance Minimization Algorithm For The Continuous Kalman Filter James Turner	
12:00 - 1:30	<i>Lunch Key Note Space Commercialization Panel Speakers:</i> Former astronauts Chris Ferguson, Lee “Bru” Archambault, and Arturo Machuca from the Houston Airport Director's Office			

Afternoon program – Session C

	Discovery (1)	Rio Grande (2)	Longhorn (3)	Lone Star (4)
	Session C-1: Theme – Robotics and History Chair: Dr. Zafar Taqvi	Session C-2: Theme –Astrodynamics Chair: Dr. Al Jackson	Session C-3: Theme – EVA and Space Exploration Chair: Larry Friesen	Session C-4 Theme – Systems Eng (INCOSE)
1:45 - 2:10	C-1.1 NOAA and the ARCs Dr. Paul Frenger, MD	C-2.1 Gravity Losses, the Rocket Equation and “U” Wes Kelly	C-3.1 Integration of Optimized Leading Edges onto Wave Rider Configurations Patrick Rodi, Ph.D.	INCOSE-3 Railroad Accident Investigation Smokey Culver
2:10 - 2:35	C-1.2 Design and Implementation of a Semi-Autonomous Mobile Robot Prototype Fatih Karabacak	C-2.2 Stability of Lunar Distant Retrograde Orbits Gary Turner, Ph.D.	C-3.2 INCOSE – Look Ahead and Listen Now Terry Hill	
2:35 - 3:00	C-1.3 Suddenly Tomorrow Came – The Audiobook Project Ted Kenny	C-2.3 The Casimir Effect: Traveling Faster than Light John M. Dilorio	C-3.3 MAJIC: A Gyroscopically Actuated Astronaut Mobility Unit for Future EVA Missions Michele Carpenter, Ph.D.	
3:00 - ???	Social at Perry's Steakhouse 487 Bay Area Blvd., Houston, TX 77058			



SYMPOSIUM LOCATION

The American Institute of Aeronautics and Astronautics (AIAA), Houston Section, welcomes you to the 2014 Annual Technical Symposium at NASA/JSC Gilruth Center on May 9, 2014.

Enter Gilruth Center using JSC Public Access Gate 5 on Space Center Boulevard if you do not have a JSC badge. The morning and afternoon technical presentations are in the Lone Star, Longhorn, and Coronado rooms on the second floor, and the Discovery Room on the first floor. The morning keynote speech and the luncheon are on the first floor in the Alamo Ballroom.

The Gilruth Center will offer free internet for ATS.

Guest Credentials

User: group1430

Password: 20grp143014

How to connect:

1. Turn on the wireless card and ensure you are near a Wireless Access Point
2. In your wireless client utility, specify the SSID to "nasaguest" to connect to the guest network. Alternatively, you can scan for wireless networks and select the network labeled "nasaguest" from the list of networks your wireless card finds.
3. Open a Web Browser (IE, Firefox, etc.). You will then be re-directed to the JSC Guest Captive Portal Access Login page.
4. At the Captive Portal Login page, enter the user ID and password enclosed in this email and click connect.
5. You will then be connected to the guest network.

Encryption

The JSC Guest Network does not require the configuration of any type of encryption to connect. Furthermore, all traffic on the Guest Network will not be encrypted.

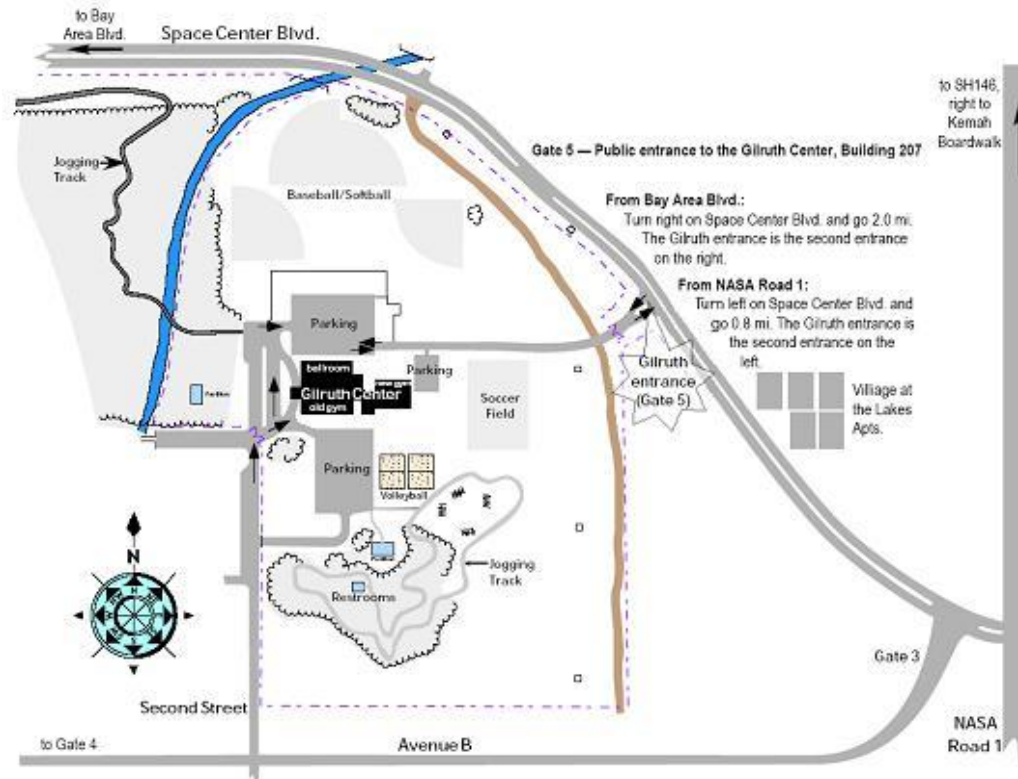

Figure 1. JSC Gate 5 Public Entrance Map



Figure 2. Gilruth Center First Floor

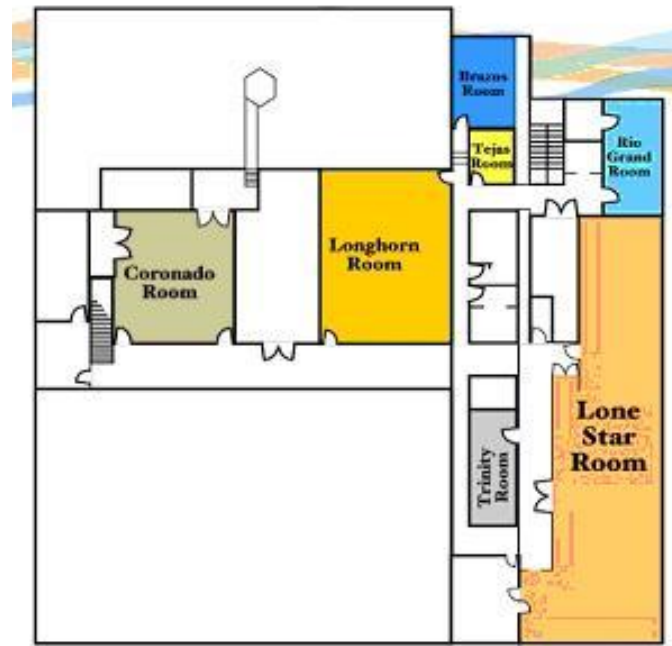

Figure 3. Gilruth Center Second Floor

SYMPOSIUM INFORMATION

REGISTRATION

Registration is free for presenters, \$15 AIAA Student Members, \$20 for AIAA and INCOSE Members, and \$25 for non-members. All registrations include a light breakfast and lunch for all attendees and is open all day beginning at 7:45 AM. Advance reservations are recommended but not required. Advance registration is easy to do on the web at www.aiaahouston.org. The registration desk is located in the hallway leading to the Alamo Ballroom. Registration is paid online. There is no additional fee for the buffet lunch – the cost is included in the registration fee.



SPECIAL EVENTS

Morning, 8:00-9:00 AM, Alamo Ballroom

Keynote Speakers: Pete Hasbrook
"State of the ISS"

Complimentary coffee, bottled water, assorted juices, and breakfast food provided

Lunch, Noon–1:30 PM, Alamo Ballroom

Space Commercialization Keynote Speaker Panel: Chris Ferguson, Lee “Bru” Archambault, and Arturo Machuca.

*Blue's Town BBQ Buffet, baked beans, potato salad, Texas toast, fruit cobbler
Fresh Brewed Starbucks Coffee, Iced Tea*



TECHNICAL PROGRAM

TECHNICAL SESSIONS

Three sessions will run in parallel in the morning and afternoon. Morning sessions start at 9:00 AM and end by noon. Lunch program begins at 12 noon and lasts for about an hour and fifteen minutes. Afternoon sessions start at 1:30 PM and end by 3:00 PM.

The sessions are held in one meeting room on the first floor and three meeting rooms on the second floor of the Gilruth Center.

PRESENTATIONS

Each presentation is allocated 30 minutes total time, including questions and any initial setup. Session chairs will maintain this pace to ensure that attendees can see presentations according to the posted schedule. Each room will be equipped with a laptop computer supplied by the Session Chair.